



# **AUTISM FRIENDLY PRE VISIT GUIDE**

## **Welcome to Rathfriland Community Centre**

[armaghbanbridgecraigavon.gov.uk](http://armaghbanbridgecraigavon.gov.uk)  
@abcb\_council



**Armagh City  
Banbridge  
& Craigavon**  
Borough Council

# AUTISM FRIENDLY PRE VISIT GUIDE

Everyone feels different when trying something new.  
There are new sounds, smells and you may not know what to expect.

## Location of Rathfriland Community Centre

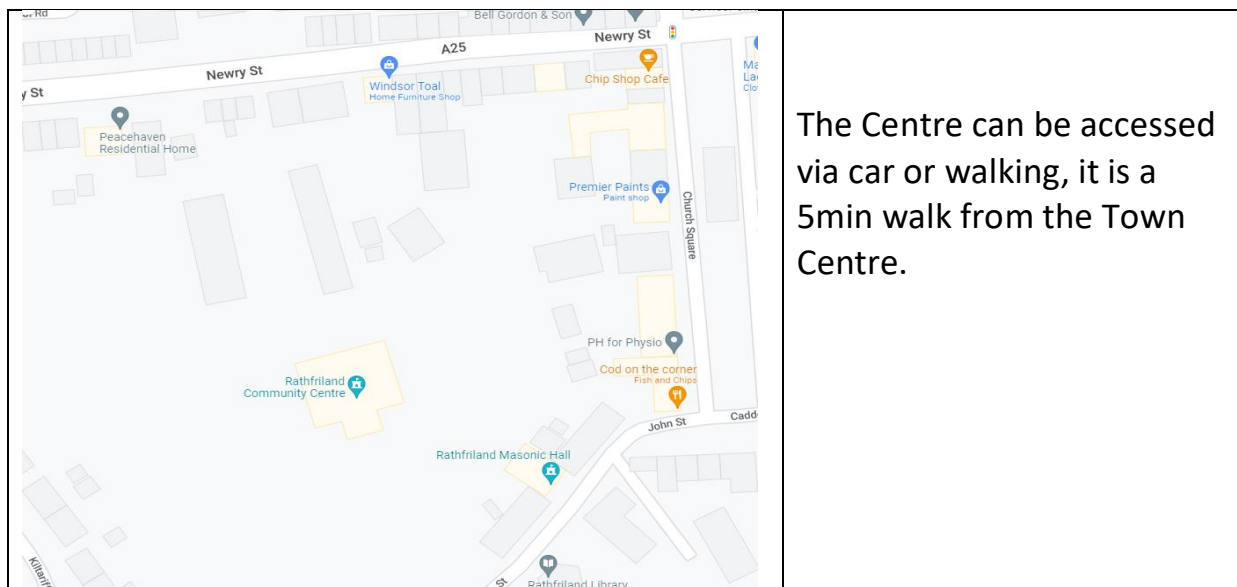

When you arrive at Rathfriland Community Centre, you enter via the car park





# AUTISM FRIENDLY PRE VISIT GUIDE

You can play in the park



## Rathfriland Play Park



### Noises you might find at the Play Park:

- Children yelling, shouting and laughing
- Motor noise from the cars in the car park

# AUTISM FRIENDLY PRE VISIT GUIDE

---

## Welcome to Rathfriland Community Centre



## Entrance – This is the entrance into Rathfriland Community Centre





# AUTISM FRIENDLY PRE VISIT GUIDE

## Floor Plan

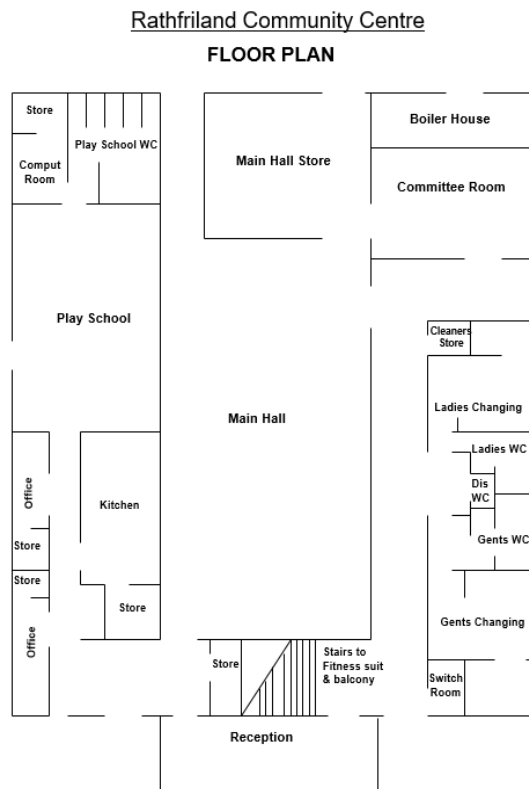

## Reception Area

When you come in, speak to a member of staff and they will advise you where you should go.



# AUTISM FRIENDLY PRE VISIT GUIDE

## Staff

During your visit to Rathfriland Community Centre if you have any questions about our facilities or activities, please speak to a member of staff. Staff can be identified by their uniform.



## Male, Female and Disabled Toilets and Changing Rooms Parent and Baby Changing



# AUTISM FRIENDLY PRE VISIT GUIDE

---

## Main Hall

The Main Hall can facilitate many sports such as Badminton, Football, Martial Arts and Netball. Fitness classes and Birthday Parties are also held in the Main Hall.



## Noises you might hear in the Main Hall:

- Loud music playing when exercise classes are in progress.
- Shouting when some sports are being played
- Children shouting and laughing at a party
- Motor noise coming from the blowers if the bouncy castle is inflated
- Fire alarm testing, music and public announcements through speakers

## Smells you might notice in the Main Hall:

- Food, Tea and Coffee at Birthday Parties
- Cleaning Products after the hall has been cleaned

# AUTISM FRIENDLY PRE VISIT GUIDE

---

## Kitchen



### Noises you might hear in Kitchen:

- People talking loudly
- Fire alarm testing, music and public announcements through speakers

### Smells you might notice in Kitchen:

- Food, Tea and Coffee
- Cleaning products

## Committee Room

The Committee Room is used for meetings.



### Noises you might hear in Committee Room:

- Fire alarm testing, music and public announcements through speakers

### Smells you might notice in Committee Room:

- Cleaning products



# AUTISM FRIENDLY PRE VISIT GUIDE

## Fitness Suite

Is on the first floor



### Noises you might hear in the Fitness Suite:

- Loud music playing
- Heavy weight equipment clanging and banging together
- Customers talking loudly to each other
- The whirr of machines being used by customers
- Fire alarm testing and public announcements through speakers
- Two way radio activity and staff instruction

### Smells you might notice in this room:

- Cleaning products

We hope this guide helps you navigate your way around our facility and makes it easier when you come and visit us.

**We hope to see you soon on your visit.**

**For further information please contact**  
Armagh City, Banbridge and Craigavon Borough Council

 0300 0300 900

 [info@armaghbanbridgecraigavon.gov.uk](mailto:info@armaghbanbridgecraigavon.gov.uk)

 [armaghbanbridgecraigavon.gov.uk](http://armaghbanbridgecraigavon.gov.uk)

  Find us on Facebook and Twitter



**Armagh City  
Banbridge  
& Craigavon**  
Borough Council