

1. GX Rowers replaced with Concept II Rowers
2. Watt Bike replaced with IC8 Cycle
3. 2no Assault Bike added to layout.
4. 1no Drax Tread added to layout
5. Strength layout updated to suit additional equip items as noted points 3 & 4 above.
6. 1no PL Linear Leg Press added to layout.
7. 1no Olympic Decline Bench omitted.
8. 2no plate tree added to layout.
9. 2no benches (24) relocated.
10. Free-weights area - layout adjusted to suit add/omits listed above.
11. Area of rubber FW flooring extended to encompass items 12 & 13.
12. Equipment Item 26 omitted.

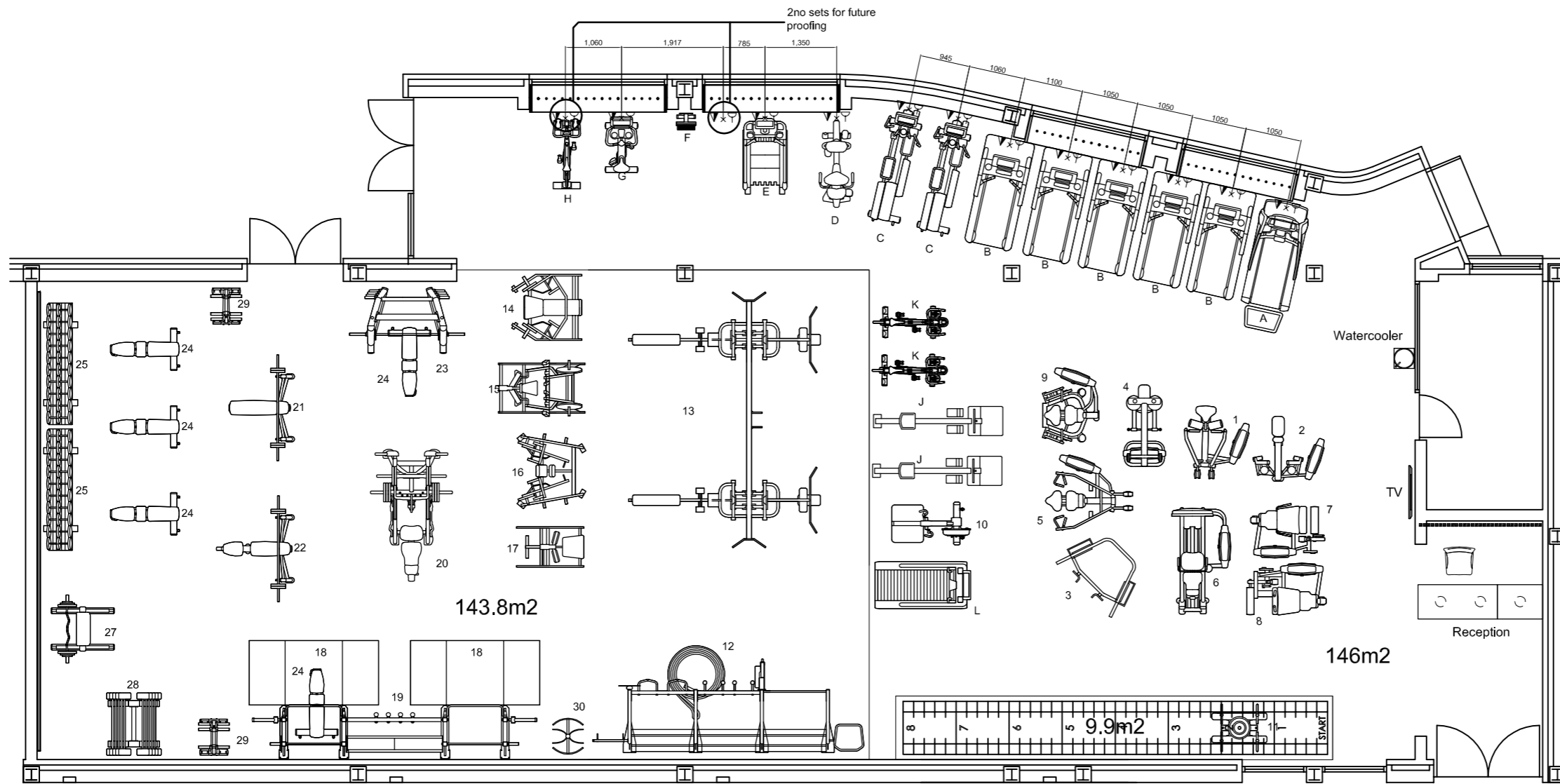

LEGEND

- 13 amp low level socket
- low level co axial
- low level data point
- 20 amp low level socket

ELECTRICAL NOTES

THIS DRAWING INDICATES FITNESS SUPPLIER SMALL POWER REQUIREMENTS AND SHOULD BE READ IN CONJUNCTION WITH ANY RELEVANT CONSULTANTS SERVICE DRAWINGS.

USE OF SKIRTING TRUNKING/ FLOOR SOCKETS/BOXES TO BE SPECIFIED BY OTHERS. PRODUCT SPECIFICATION/FINISH TO BE AGREED.

ELECTRICAL CONTRACTOR TO ENSURE COMPLIANCE WITH ALL RELEVANT PERMISSIONS AND REGULATIONS AS RELEVANT.

ELECTRICAL CONTRACTOR TO LIAISE WITH FITTR ON EXACT LOCATIONS OF ALL VISIBLE FIXTURES

THIS DRAWING RELATES SOLELY TO SERVICES REQUIRED FOR FITNESS EQUIPMENT. EXCLUDED FROM THIS DRAWING ARE :
SOUND SYSTEM, WELCOME DESK SERVICE REQUIREMENTS, CLEANER SOCKETS, ANY POWER RELATING TO SUNDRY ITEMS SUCH AS WATER COOLERS OR SIMILAR, LIGHTING & CONTROLS, MECHANICAL WORKS TO INCLUDE HEATING AND COOLING, VENTILATION, FIRE ALARM, SMOKE DETECTION ETC.

SMALL POWER PROVISION MAY BE SUBJECT TO CHANGE IN LINE WITH ANY FURTHER DEVELOPMENT TO EQUIPMENT SPECIFICATIONS OR LAYOUTS .

CONTRACTOR IS RESPONSIBLE FOR CROSS CHECKING SETTING OUT PRIOR TO COMMENCING WORKS. ANY ISSUES TO BE RAISED TO FITTR AND/OR THE ELECTRICAL CONSULTANT.

PROPOSED PLAN

Cardiovascular Equipment

- A Treadmill - IFI
- B Treadmill - S Base SE3HD x 5
- C Cross-Trainer - S Base SE3HD x 2
- D Recumbent Lifecycle - IFI
- E Power Mill - Discover SE3HD
- F Concept II SkiErg - Wall
- G Upright Bike - S Base SE3HD
- H Indoor Cycle - IC8
- J Concept II Rower x 2
- K Assault Bike x 2
- L Drax Non Power Treadmill

Resistance Equipment

- 1 Row - Insignia
- 2 Pulldown - Insignia
- 3 Dual Adjustable Pulley - IFI
- 4 Fly/Delt - Insignia
- 5 Shoulder Press - Insignia
- 6 Seated Leg Press - Insignia
- 7 Leg Extension - Insignia
- 8 Seated Leg Curl - Insignia
- 9 Chest Press - Insignia
- 10 GX Upper Cycle
- 11 Push / Pull Sled
- 12 Synrgy 180 - Mix3
- 13 Multi-Jungle SM-80
- 14 Iso-Lateral Bench Press - HPL
- 15 Iso-Lateral Front Lat Pulldown - HPL

- 16 Iso-Lateral D.Y. Row
- 17 Seated Calf Raise - HPL
- 18 4' X 8' Platform - HDE x 2
- 19 Perimeter Rack - dble
- 20 PL Linear Leg Press - Sig
- 21 Olympic Flat Bench - Sig
- 22 Olympic Incline Bench - Sig
- 23 Smith Machine - Sig
- 24 Multi-Adjustable Bench - Sig x 5
- 25 Dumbbell Rack Double x 2
- ~~26 Dumbbell Rack Single~~
- 27 Arm Curl Bench - Sig
- 28 Barbell Rack
- 29 Plate Tree x 2
- 30 Double Medicine Ball Rack



WWW.FITTR.IE
T: +353 1 531 0190

CLIENT	ABC COUNCIL
PROJECT	BANBRIDGE LEISURE CENTRE
DRAWING	PROPOSED FITNESS EQUIPMENT, SMALL POWER
SCALE	1:100 @ A3
REVISION	A
DWG NO	20-002-102
DATE	20.02.2020

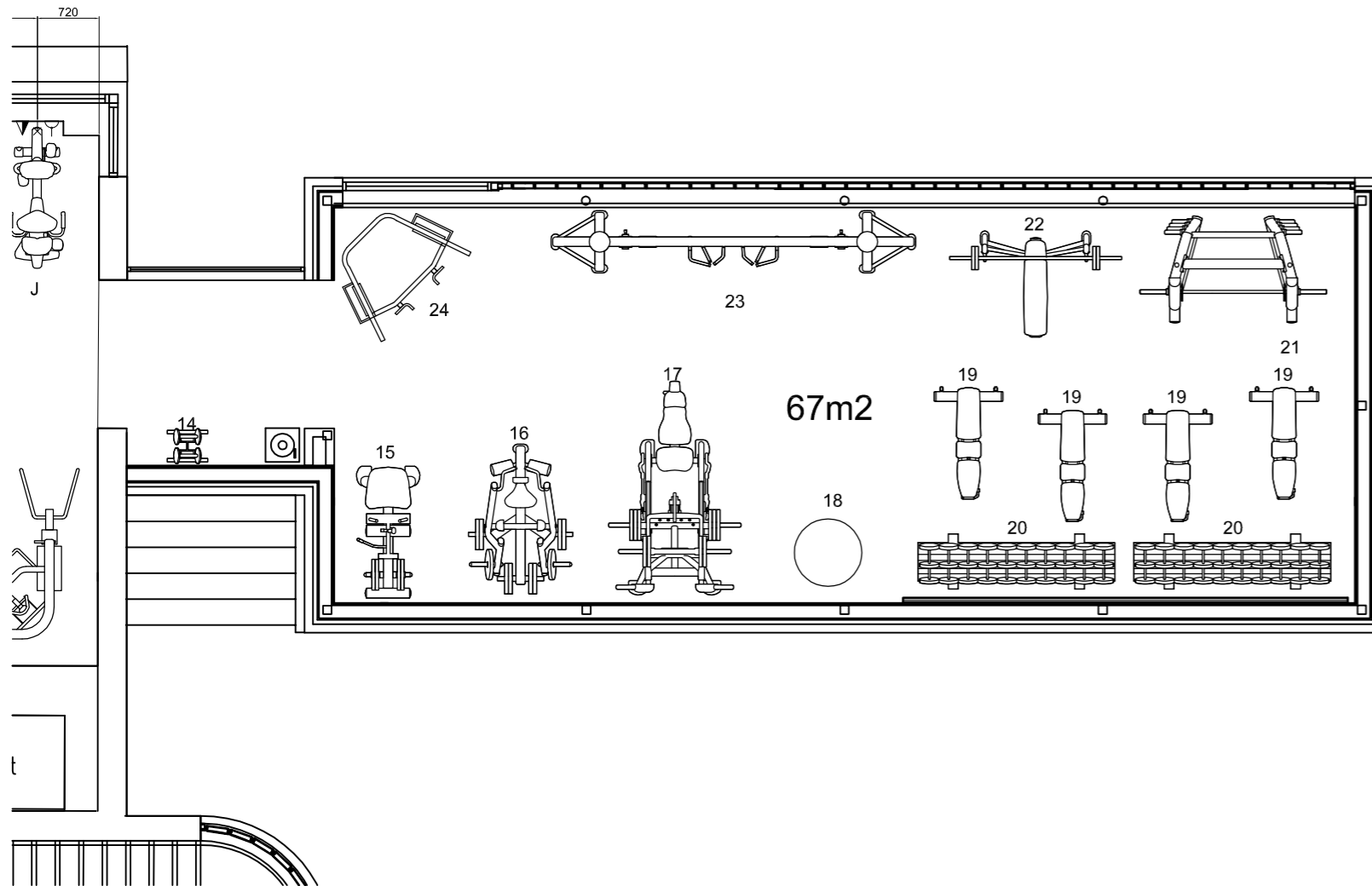
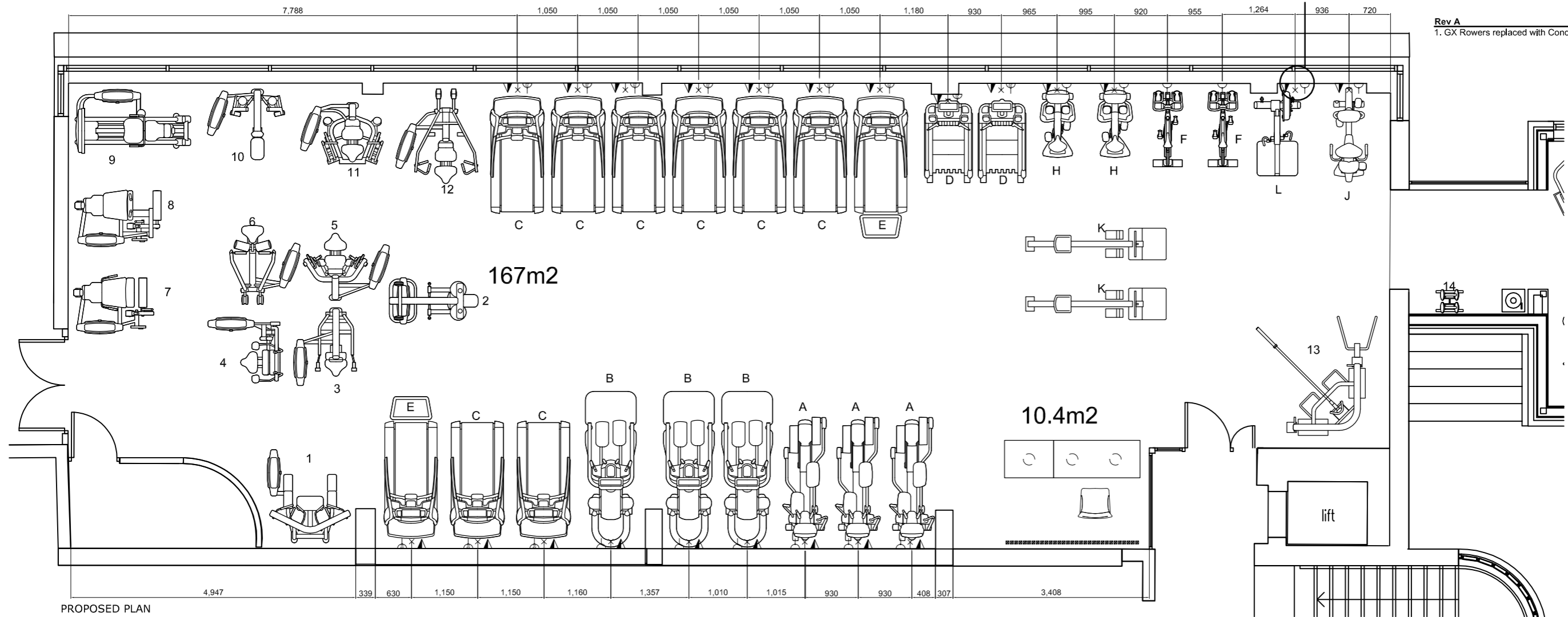

LEGEND

- 13 amp low level socket
- low level co axial
- low level data point
- 20 amp low level socket

ELECTRICAL NOTES

THIS DRAWING INDICATES FITNESS SUPPLIER SMALL POWER REQUIREMENTS AND SHOULD BE READ IN CONJUNCTION WITH ANY RELEVANT CONSULTANTS SERVICE DRAWINGS.

USE OF SKIRTING TRUNKING/ FLOOR SOCKETS/BOXES TO BE SPECIFIED BY OTHERS. PRODUCT SPECIFICATION/FINISH TO BE AGREED.

ELECTRICAL CONTRACTOR TO ENSURE COMPLIANCE WITH ALL RELEVANT PERMISSIONS AND REGULATIONS AS RELEVANT.

ELECTRICAL CONTRACTOR TO LIAISE WITH FITTR ON EXACT LOCATIONS OF ALL VISIBLE FIXTURES

THIS DRAWING RELATES SOLELY TO SERVICES REQUIRED FOR FITNESS EQUIPMENT. EXCLUDED FROM THIS DRAWING ARE :
SOUND SYSTEM, WELCOME DESK SERVICE REQUIREMENTS, CLEANER SOCKETS, ANY POWER RELATING TO SUNDRY ITEMS SUCH AS WATER COOLERS OR SIMILAR, LIGHTING & CONTROLS, MECHANICAL WORKS TO INCLUDE HEATING AND COOLING, VENTILATION, FIRE ALARM, SMOKE DETECTION ETC.

SMALL POWER PROVISION MAY BE SUBJECT TO CHANGE IN LINE WITH ANY FURTHER DEVELOPMENT TO EQUIPMENT SPECIFICATIONS OR LAYOUTS .

CONTRACTOR IS RESPONSIBLE FOR CROSS CHECKING SETTING OUT PRIOR TO COMMENCING WORKS. ANY ISSUES TO BE RAISED TO FITTR AND/OR THE ELECTRICAL CONSULTANT.

- Cardiovascular Equipment**
- A Elliptical Cross-Trainer - Discover SE3HD x 3
 - B Flex Strider - Discover SE3HD x 3
 - C Treadmill - Discover SE3HD x 8
 - D Power Mill - Discover SE3HD x 2
 - E Treadmill - IFI x 2
 - F Indoor Cycle - IC8 - MyridePersonal x 2
 - H Upright Lifecycle - Discover SE3HD x 2
 - J Recumbent Lifecycle - IFI
 - K Concept II Rower x 2
 - L GX Upper Cycle

- Resistance Equipment**
- 1 Assist Dip Chin - Insignia
 - 2 Fly/Delt - Insignia
 - 3 Tricep Press - Insignia
 - 4 Abdominal - Insignia
 - 5 Bicep Curl - Insignia
 - 6 Pulldown - Insignia
 - 7 Leg Extension - Insignia
 - 8 Seated Leg Curl - Insignia
 - 9 Seated Leg Press - Insignia
 - 10 Row - Insignia
 - 11 Chest Press - Insignia
 - 12 Shoulder Press - Insignia
 - 13 Synrgy 90 Versa-Versa
 - 14 Vertical Dumbbell Rack - FW
 - 15 Calf - SPL
 - 16 Pull Down - SPL
 - 17 Linear Leg Press - SPL
 - 18 Olympic Bar Holder
 - 19 Multi-Adjustable Bench - Sig x 4
 - 20 Dumbbell Rack Double x 2
 - 21 Smith Machine - Sig
 - 22 Olympic Flat Bench - Sig
 - 23 Cross Over - CM
 - 24 Dual Adjustable Pulley - IFI



CLIENT	ABC COUNCIL
PROJECT	ORCHARD LEISURE CENTRE
DRAWING	PROPOSED FITNESS EQUIPMENT, SMALL POWER
SCALE	1:75 @ A3
REVISION	A
DWG NO	20-002-105
DATE	20.02.2020